

George.
home

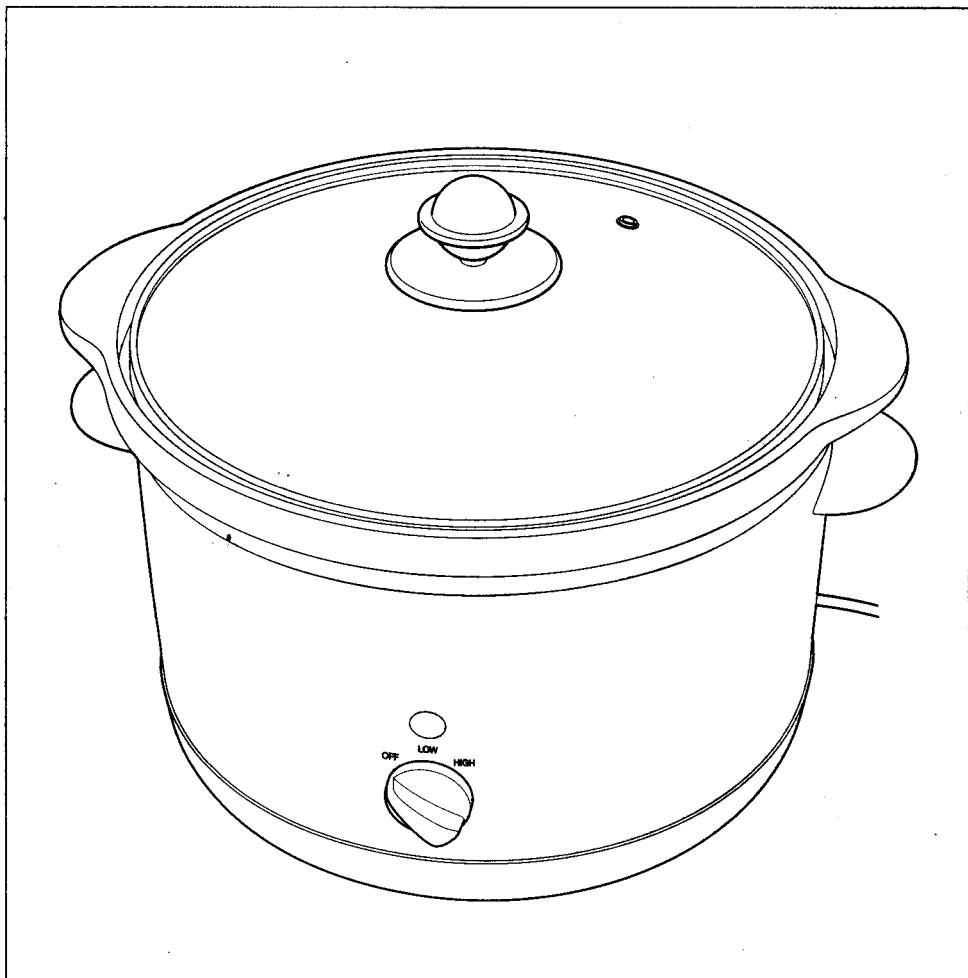

GSC101SS 3.0L Slow cooker

User Guide

220-240V~50Hz, 152-180W

IMPORTANT: RETAIN FOR FUTURE REFERENCE

About this guide

We're here to help you get the most from your slow cooker, so please keep hold of this manual for future use.

WARNINGS:

THIS PRODUCT WAS DESIGNED AND MANUFACTURED TO MEET STRICT QUALITY AND SAFETY STANDARDS. THERE ARE, HOWEVER, SOME OPERATIONAL PRECAUTIONS THAT YOU SHOULD BE AWARE OF.

1. Read all warnings & instructions in this manual to ensure you get the best out of your product.
2. For household use only.
3. ✓ If the supply cord is damaged, it must be replaced by the manufacturer, its service agent or similarly qualified persons in order to avoid a hazard.
4. To protect against electric shock do not immerse the cooker body, power cord or plug in water or any other liquid.
5. Unplug when not in use or before cleaning.
6. This appliance can be used by children aged from 8 years and above if they have been given supervision or instruction concerning use of the appliance in a safe way and if they understand the hazards involved. Cleaning and user maintenance shall not be made by children unless they are older than 8 and supervised. Keep the appliance and its cord out of reach of children aged less than 8 years.
7. ASDA does not recommend allowing children to operate this appliance.
8. This appliance can be used by persons with reduced physical, sensory or mental capabilities or lack of experience and knowledge if they have been given supervision or instruction

concerning use of the appliance in a safe way and understand the hazards involved.

9. Children shall not play with the appliance.
10. Do not use the slow cooker when it is empty, as this could lead to damage.
11. Do not remove the lid when the slow cooker is in use (unless required by your recipe), otherwise the heat will dissipate and the cooking time will be affected.
12. Surfaces may become hot during use. Place on heat-resistant surfaces and do not touch hot surfaces, only use the handles and knobs.
13. Do not place frozen food or objects inside the ceramic pot when it is hot, or wash with cold water when it is hot.
14. Exercise extreme caution when moving the slow cooker when it contains hot liquid/foods.
15. Keep away from harsh or abrasive cleaning agents or solvents.
16. Remove all protective wrapping prior to use.
17. This appliance is only suitable for domestic use and it is not designed for commercial purpose.
18. Do not use if the appliance, cord or plug are damaged.
19. Always place on a firm, level surface, out of reach of children.
20. The cord shouldn't hang over the edge of a table or counter, or touch a hot surface.
21. Do not place on or near hot gas, electric burners or ovens.
22. Always allow to cool before cleaning or removing any parts of the cooker.
23. Do not use attachments not recommended by the manufacturer.
24. Don't use the slow cooker for anything other than its intended use.
25. Before connecting the slow cooker to the power, check the voltage shown on the appliance corresponds with the voltage in your home. If it doesn't contact your local store.
26. Please don't dismantle. If a fault occurs have the slow cooker inspected in a qualified repair shop or return to us at Asda.

You should have

Cooker body, ceramic pot & lid

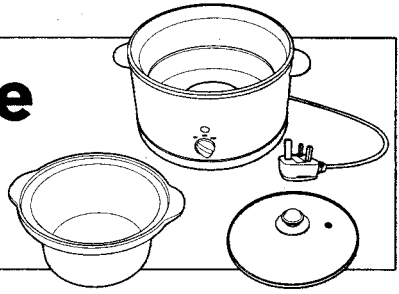

How to...

...recognise the parts of your slow cooker

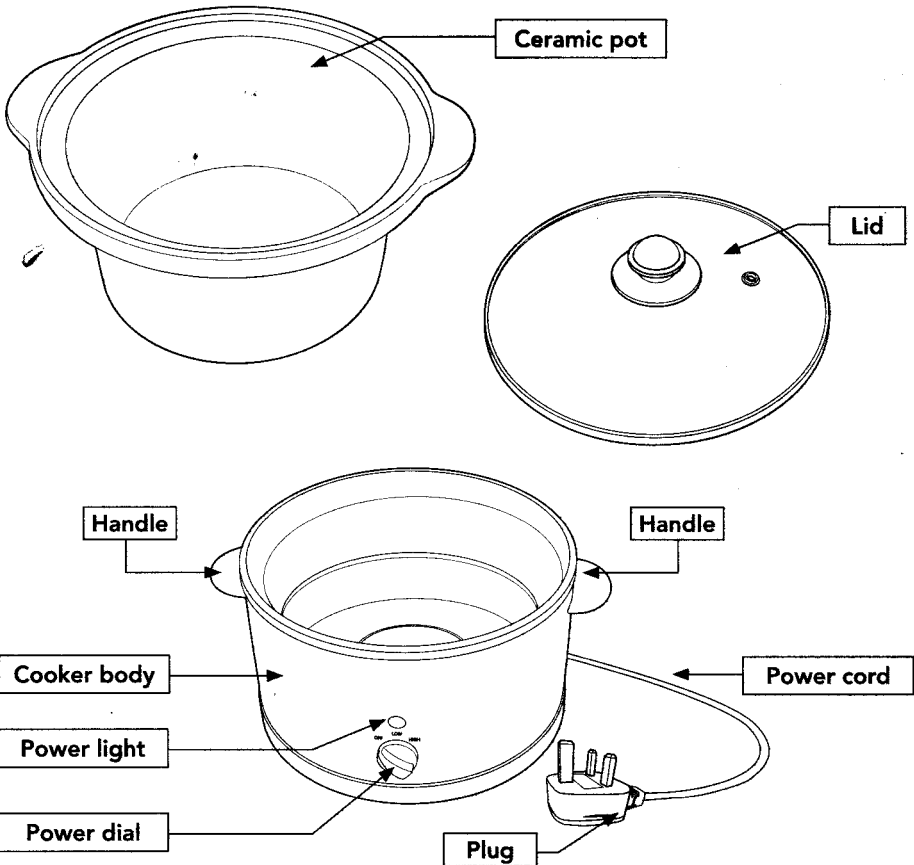

How to...

...use your slow cooker

Before use, remove all packaging and wash the ceramic pot and lid in warm soapy water. Dry thoroughly before use. Please only use plastic implements with the slow cooker as metal can cause damage.

1. Place the base of the slow cooker on a flat, stable surface near an easily accessible power socket.

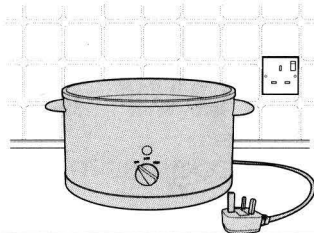

2. Prepare all of the ingredients for your meal and place them in the ceramic pot. The pot must only be 80% full or it may leak into the cooker body and cause damage.
3. Place the ceramic pot into the cooker body.

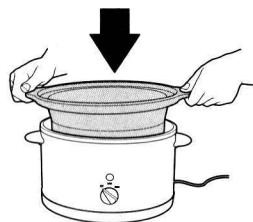

4. Place the lid onto the top of the pot.

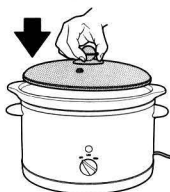

5. Slot the plug into the electrical socket and turn the power on.

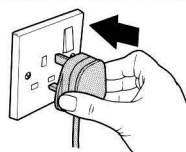

6. Turn the power dial to either low or high to cook your food. The cooking light will come on to show you that the slow cooker is working. When cooking, do not remove the lid unless it is to add ingredients, or this will increase the cooking time.

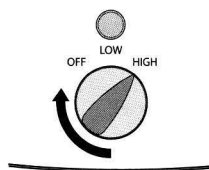

Function	Guidelines	Recipe	Working temperature	Suggested cooking time
HIGH	Use this setting when you do not have time for a slow cooked meal.	Casseroles & puddings.	Approximately 100 °C.	3 to 8 hours depending on the food being cooked.
LOW	Low is the standard slow cooker temperature, it is ideal for foods that you start cooking in the morning before work and enjoy at the end of your day.	Braising roasts, stews, ribs, casseroles, and less tender cuts of meat.	Approximately 95 °C.	6 to 12 hours depending on the food being cooked.

7. Once your food is cooked, turn the power dial to the off position.

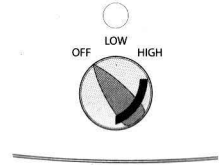

8. Switch the power off at the socket and remove the plug.

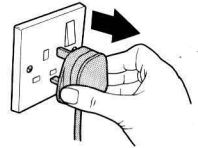

9. Take off the lid, being careful to avoid any steam, and place the lid on a heatproof surface (it will be very hot).
You can now serve the meal.

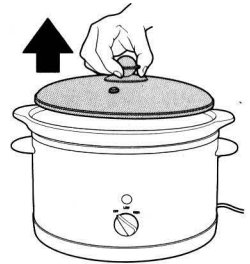

10. Allow the ceramic pot to cool completely before removing it for cleaning.

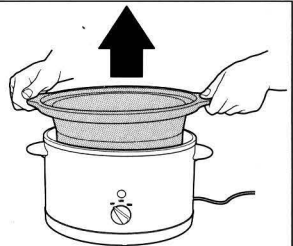

How to...

...clean your slow cooker

Make sure the slow cooker is disconnected from the power and is completely cool.

1. Carefully lift the ceramic pot out of the cooker body and wash the pot and lid in warm soapy water. They may also be washed in the dishwasher, but this could cause the surfaces to dull over time.
2. Wipe the outside of the cooker body with a damp cloth and dry carefully.
3. Ensure the slow cooker and lid are all dried thoroughly before storing.

How to...

...change the fuse

1. Only use a 5 amp fuse.
2. To change the fuse, place a screwdriver into the recess of the plug cover and pull the fuse holder upward until it's free.
3. Slide the fuse out and pop in the replacement.
4. Slot the fuse holder back into the recess and push down until it locks into place.

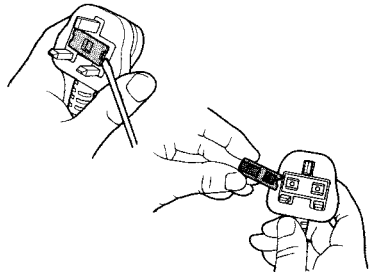

Notes...



If for any reason you're not completely satisfied with our product, return it within 100 days with your proof of purchase, and we'll give you an exchange or a refund.

UK Mainland stores only.

Excludes franchises.

The guarantee excludes flat pack furniture, which can't be returned if it has been partly or fully assembled unless faulty or mis-described.

Also excludes mattresses, which can't be returned for hygiene reasons once used, unless faulty or mis-described.



Need something else?

www.GEORGE.com

We have a wide range of accessories and other products that can be ordered direct to your door.

Customer services information

If you have any problems, need more information or spare parts, or even just some advice on your product, then don't hesitate to contact customer services at the telephone number or address shown opposite. N.B. When calling or writing please have your product site code handy.

Call

0800 952 0101

Write

ASDA Stores Ltd. Asda House, Southbank, Great Wilson Street, Leeds, LS11 5AD.

Product name: **GSC101SS 3.0L Slow cooker**

Product site code: **15A.08.15.136**



To qualify for the 2 year warranty the appliance must have been used according to the manufacturer's instructions. For example kettles should have been regularly de-scaled.

If your appliance stops working or develops a fault then return it to your nearest store and we will happily replace or refund the item, with exception of the below exclusions:

EXCLUSIONS

ASDA shall not be liable to replace goods under the terms of the warranty where:

1. The fault has been caused or is attributable to accidental use, misuse, negligent use or use contrary to the user manual's recommendations or where the fault has been caused by power surges or damage caused in transit.
2. The appliance has been used on a voltage supply other than that described on the product rating label.
3. Repairs have been attempted by persons other than our service staff (or authorised dealer).
4. Where the appliance has been used for hire purposes or non-domestic use.
5. ASDA are not liable to carry out any type of servicing work, under the warranty.

This warranty does not confer any rights other than those expressly set out above and does not cover any claims for consequential loss or damage. This warranty is offered as an additional benefit and does not affect your statutory rights as a consumer.

If for any reason this item is replaced during the 2 year warranty period, the warranty on the new item will be calculated from original purchase date. It is vital to retain your original proof of purchase to indicate the date of initial purchase.

Copyright

© 2015 ASDA Stores Limited.
All other trademarks appearing herein are the property of their representative owners.
Specifications are subject to change without notice.

Manufactured for:

ASDA Stores Ltd. Asda House, Southbank,
Great Wilson Street, Leeds, LS11 5AD.

Disposal

This symbol on the product or in the instructions means that your electrical and electronic equipment should be disposed at the end of its life separately from your household waste. There are separate collection systems for recycling in the EU.

For more information, please contact the local authority or your retailer where you purchased the product.

